

RF351ICAT

3 1/2" New Construction Airtight Housing for Insulated Ceilings Recessed Lighting

Job Information		
Project Name		Type
Location		
Quantity		Date
Contact/Phone		
Notes		

Features

New Construction Housing

Constructed of aluminum and 22ga galvanized steel for optimum rigidity. The frame includes a 1/2" (13mm) deep collar to assist with drywall installations and standard ceilings.

Junction Box

Listed for through branch circuit wiring. Maximum eight no. 12 AWG 90°C branch circuit conductors (four in and four out). Five 1/2" knockouts with true pry-out slots and four knockouts with Romex® cable clamp. Ground wire is provided on J-Box. Three "quick connects" for fast and easy wiring.

Mounting Frame

Constructed of galvanized steel with an adjustable trim collar to accommodate ceilings up to 1-1/4" (32mm) thick.

Hanger Bars - 4 Sides

With a maximum extension of 25", these hanger bars can be placed on all sides and allow excess distance between joists. Housing can be positioned at any point along the joist span and secured

in place with oversized locking screw. Score lines on the hanger bars allows for toolless shortening for 12" joists. Integral T-bar clips easily snap onto T-bars.

Thermal Protection

Self resetting thermal protector deactivates fixture if overheating occurs due to improper lamping or misapplied insulation.

Socket

Ceramic socket for medium based PAR16 or PAR20 lamps.

Lamps

- LED PAR16, 8W max.
- LED PAR20, 8W max.

Listing

- cETLus listed for damp locations.

HOUSING SPECIFICATIONS

Airtight	Yes
Aperture	3 1/2"
Application	Recessed
Approved Location	Damp
Base	E26
Box Type	White
Certification	cETLus
Cut Hole	3-7/8"
Housing Type	IC
Lamp Type	PAR16/PAR20 LED
Material	Aluminum & Steel
Max. Watt	8W
Primary Voltage	120V



Description

The RF351ICAT is a 3 1/2" aperture line voltage housing for use in new construction application in insulated ceilings. The RF351ICAT features a medium socket and offers a wide choice of trim types including refl. ect., wall wash and retractable trims.

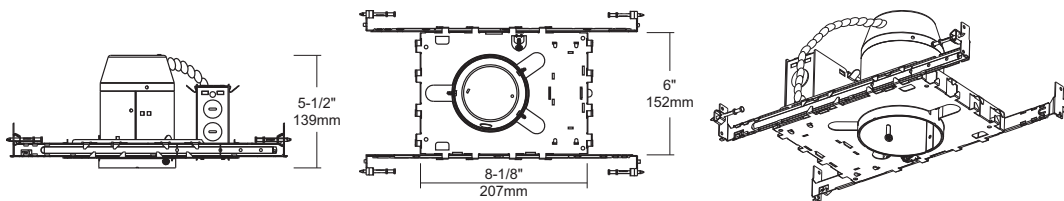

Notes: Accessories should be ordered separately. For additional options please consult your Liteline representative. Romex is a registered trademark of Southwire Company. Due to our continued efforts to improve our products, product specifications are subject to change without notice.

Ordering Guide



RF351ICAT

3 1/2" new construction airtight housing for insulated ceilings, medium base socket.

